

## ROLLER BALL SWITCH

### SPECIFICATIONS:

Current Rating:	.2A @ 12VDC				
Mounting Centers:	1.16"				
Mounting Hole:	.12"				
Dimensions:	.85" W x 1.6" L x 1.8"H				
Terminal Type:	10" Leads, 24 AWG				
Part No.	Type	Action			Actuator
30-17070	SPST	OFF	-	(ON)	Roller Ball

Note: ( ) = Momentary

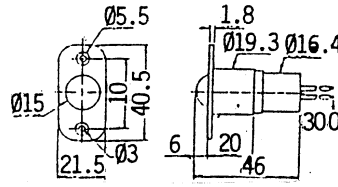

## SNAP-IN TAMPER SWITCH

### SPECIFICATIONS:

Current Rating:	1A @ 125VAC				
Terminal Type:	.250" Quick Connect				
Part No.	Type	Action			Actuator
30-17074	SPST	OFF	-	(ON)	Plastic (.55" H.)

Note: ( ) = Momentary

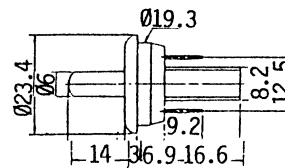

Mounting Hole: 0.75"



ELECTRICAL RATING; UL Listed SPST Switch.  
 Current Rating: 5A @125 VAC  
 Insulation Resistance: @DC 500V 100 Megohms  
 Withstand Voltage: AC 1500V 1 minute  
 Contact Resistance: DC 2-4V 1A 100 milliohms-ohms or less.  
 Life: 100,000 cycles at 5 Amps  
 Minimum stroke to open contacts is 0.5mm from full open position  
 Action: (OFF) - ON

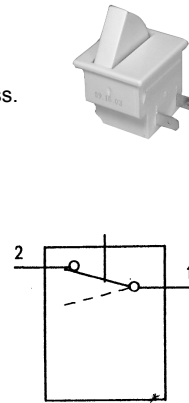
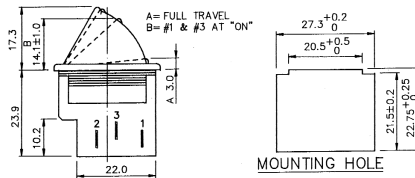

## FRIG SWITCH- SPST

Designed for use in a refrigerator as a light switch, turning "on" when the door is opened. Switch is normally on until the activator is depressed; or pushed down by a closing door. For mounting in metal panel. Can be used in "dead mans" switch applications. Applications could include alarm systems, hood up indicator switch etc.

No. 30-17065

ELECTRICAL RATING:  
 not UL Listed SPST Switch  
 Current Rating: 2A @125 VAC, 1A @250 VAC  
 Insulation Resistance: @DC 500V 50 Megohms  
 Withstand Voltage: AC 1500V 1 minute  
 Minimum stroke to open contacts is depressing actuator by .020" or 0.5mm from fully relaxed position.  
 ACTION: (OFF)- ON

## Round Hole Mounting Plunger TAMPER SWITCH

A very economical switch. Mounts in 3/8" round hole (panel thickness up to 1/10"). The switch is normally closed (on) when the actuator is fully extended and open (off) when the actuator is depressed .020" travel distance. Total actuator travel distance is 0.40"

No. 30-17063

