

SWITCHES HEAVY DUTY SNAP ACTION & DIP SWITCHES

SPECIFICATIONS:

| | | | | |
|------------------------------------|---|-------------|-----------------------|--------------------|
| Current Rating: | 15A @ 125/250V AC 1/2A @ 125V DC, 1/4 HP @ 250V DC 1/8 HP @ 125V AC, 1/4 HP @ 250V AC | | | |
| Initial Contact Resistance: | 15 Meg ohm (Max.) | | | |
| Insulation Resistance: | 500V DC 1000 Meg ohm (Min.) | | | |
| Dielectric Strength: | 1000V AC for 1 Minute | | | |
| Contact Material: | Silver | | | |
| Terminal Material: | Brass - Silver Plate | | | |
| Terminal Type: | Screw | | | |
| Part No. | Replaces | Type | Action | Actuator |
| 30-1744 | AM1744 | SPDT | Snap Action Momentary | Short Roller Lever |

SPECIFICATIONS:

| | |
|--------------------------|-------------------------|
| Terminal: Screw | OT Min.: 5.5mm |
| OF Max.: 250-350g | MD Max.: 0.05mm |
| RF Min.: 114g | OP: 21.8 ± 0.8mm |
| PT Max.: 0.4mm | |

HEAVY DUTY SNAP ACTION SWITCH with HINGED ROLLER LEVER

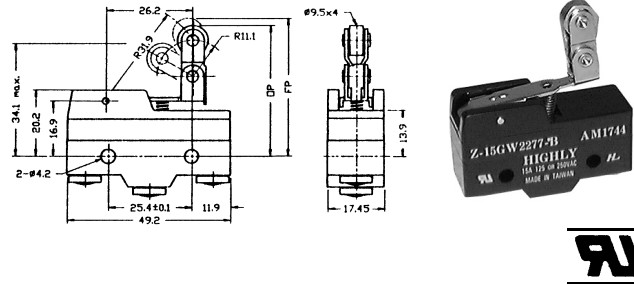

SPECIFICATIONS:

| | | | |
|-------------------------------|-------------------------------|-------------------------|---------------------|
| ELECTRICAL RATINGS: | | | |
| 15A | 125-250V AC 65C | UL E91973 CSA LR98589-1 | |
| 1/2HP | 125-250V AC | UL/CSA | |
| 15A | 250V AC T125 | VDE 4715UG | |
| MATERIALS: | | | |
| Operating Force (Nom): | 280g (10 oz) | | |
| Endurance (Mech): | >10 ⁶ Operations | | |
| Flame Retardancy: | UL 94 V2 | | |
| Actuator: | Nylon 6.6 - V Stainless Steel | | |
| Mounting Bracket: | Nylon 6.6 | | |
| Contacts: | Fine Silver u gap | | |
| Part No. | Type | Action | Actuator |
| 30-383 | SPDT | Normally Open/Closed | Red w/ Black Shroud |

MOMENTARY PUSH BUTTON SNAP ACTION SWITCH

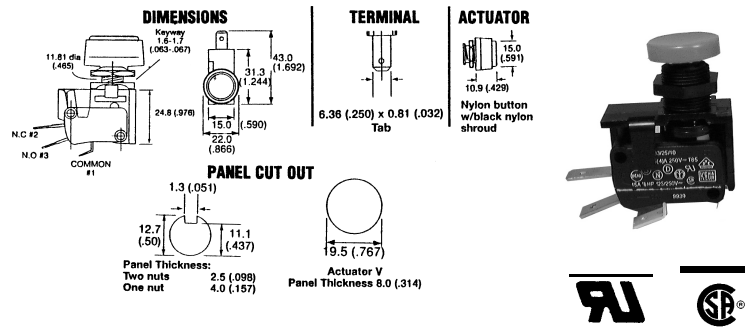

SPECIFICATIONS:

| | |
|------------------------------------|---|
| Contact Rating: | 50V DC 100mA @ Steady Situation 24V DC 25mA @ Make or Break |
| Initial Contact Resistance: | 100mA, 30 Meg ohm @ initial 100mA, 100 Meg ohm after life test |
| Insulation Resistance: | 500V DC 100 Meg ohm (Min.) between adjacent terminals |
| Dielectric Strength: | 500V AC for 1 minute between adjacent terminals |
| Operation Life: | 5,000 make-break cycles each circuit @ test speed of 72 cycles/min. |
| Operation Force: | 500g Max. |
| Shock: | Withstand of 20g 11ms sawtooth waveform w/no contact opening > 10 ms (microseconds) |
| Vibration: | No mechanical damage or intermittent change of setting during or after test |
| Case & Cover Material: | UL 94V-O Polybutylene Terephthalate |
| Top Seal Material: | Polyester Film |
| Potting Material: | Epoxy |
| Contact Material: | Nickel, Phosphor Bronze w/Gold Plate |
| Terminal Material: | Nickel, Phosphor Bronze w/Gold Plate |
| Terminal Type: | Solder |

| Part No. | Position | "A" Dim. in. (mm) | Actuator |
|----------|----------|-------------------------|----------------------|
| 30-11001 | 1 | .147 (3.74) | White UL 94V-O PBT |
| 30-1002 | 2 | .260 (6.6) | White UL 94V-O PBT |
| 30-1003 | 3 | .360 (9.14) | White UL 94V-O PBT |
| 30-1004 | 4 | .460 (11.68) | White UL 94V-O PBT |
| 30-11040 | 4 | .452 (11.48) | White -Side Actuated |
| 30-1005 | 5 | .560 (14.22) | White UL 94V-O PBT |
| 30-1006 | 6 | .660 (16.76) | White UL 94V-O PBT |
| 30-1007 | 7 | .760 (19.3) | White UL 94V-O PBT |
| 30-1008 | 8 | .860 (21.84) | White UL 94V-O PBT |
| 30-11080 | 8 | .845 (21.46) | White Side Actuated |
| 30-11081 | 8 | .854 (21.70) | White-Right Angle |
| 30-1009 | 9 | .960 (24.38) | White UL 94V-O PBT |
| 30-1010 | 10 | 1.06 (26.92) | White UL 94V-O PBT |
| 30-1012 | 12 | 1.26 (32) | White UL 94V-O PBT |

DIP SWITCHES

