

PUSH BUTTON CANOPY SWITCH

SPECIFICATIONS:

Current Rating:	3A @ 125V AC, 1A @ 250V AC					
Initial Contact Resistance:	DC 2.5V-1A, 20 Meg ohm (Min.)					
Insulation Resistance:	500V DC 100 Meg ohm (Min.)					
Dielectric Strength:	1500V AC for 1 minute					
Contact Material:	Brass - Bright Nickel Plate					
Terminal Material:	6" 18 AWG 105 C° Wire					
Terminal Type:	Stripped Wire Leads					
Part No.	Replaces	Type	Action			Actuator
30-1885	1885	SPST	ON	-	OFF	Black Nylon



Mounting Hole: 0.375"



PUSH BUTTON CANOPY SWITCHES

SPECIFICATIONS:

Current Rating:	6A @ 125V AC, 3A @ 250V AC, 6A @ 30 VDC, 3A @ 15VDC				
Initial Contact Resistance:	50 Meg ohm (Max.)				
Insulation Resistance:	100 Meg ohm (Min.) @ 500V DC				
Dielectric Strength:	1000V AC 60/50 Hz for 1 minute				
Terminal Material:	Brass/Nickel Plate				
Actuator Type:	Plastic				
	Red- 30-19164, Black- 30-19886				
Part No.	Type	Action			Terminal
30-19164	SPST	ON	-	OFF	Solder
30-19886	SPST	ON	-	OFF	Wire Leads



Mounting Hole: 0.400"

ROTARY CANOPY SWITCH

SPECIFICATIONS:

Current Rating:	3A @ 125V AC, 1A @ 250V AC					
Initial Contact Resistance:	DC 2.5V-1A, 20 Meg ohm (Min.)					
Insulation Resistance:	500V DC 100 Meg ohm (Min.)					
Dielectric Strength:	1500V AC for 1 minute					
Contact Material:	Brass - Bright Nickel Plate					
Terminal Material:	6" 18 AWG 105 C° Wire					
Terminal Type:	Stripped Wire Leads					
Part No.	Replaces	Type	Action			Actuator
30-9159	9159	SPST	ON	-	OFF	Knurled Plastic



Mounting Hole: 0.375"



SPECIFICATIONS:

Current Rating:	6A @ 125V AC, 3A @ 250V AC					
Initial Contact Resistance:	DC 2.5V-1A, 20 Meg ohm (Min.)					
Insulation Resistance:	500V DC 100 Meg ohm (Min.)					
Dielectric Strength:	1500V AC for 1 minute					
Contact Material:	Brass - Bright Nickel Plate					
Terminal Material:	6" 18 AWG 105 C° Wire					
Terminal Type:	Stripped Wire Leads					
Part No.	Replaces	Type	Action			Actuator
30-9157	9157	SPST	ON	-	OFF	Pull Chain

NOTE: Rope chain (No. 9157PCB) must be ordered separately.

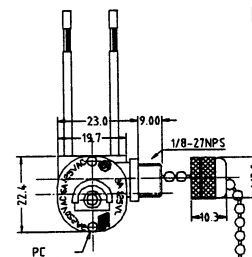

PULL CHAIN SWITCH

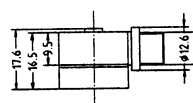

Mounting Hole: 0.406"

