

BATTERY HOLDERS

BATTERY HOLDERS

Most Battery Holders are Black Plastic



fig. 1



fig. 2



fig. 3



fig. 4



fig. 5



fig. 6



fig. 7



fig. 8



fig. 9

- fig. 1 **BH111** For (1) D Cell with Solder Lug Connection.
- fig. 2 **BH121** For (2) D Cell with Solder Lug Connection.
- fig. 3 **BH142** For (4) D Cell with Solder Lug Connection.
- fig. 4 **BH181** For (8) D Cell with Solder Lug Connection.
- fig. 5 **BH211** For (1) C Cell with Solder Lug Connection.
- fig. 6 **BH221** For (2) C Cell with Solder Lug Connection.
- fig. 7 **BH243** For (4) C Cell with Solder Lug Connection.
- fig. 8 **BH261** For (6) C Cell with Solder Lug Connection.
- fig. 9 **BH311** For (1) AA Cell with Solder Lug Connection.
- fig. 10 **BH321** For (2) AA Cells with Solder Lug Connection.
- fig. 11 **BH320** For (2) AA cell (UM-3) with cover and lead wire Connection.
- fig. 12 **BH331** For (3) AA Cells with Standard Snap Connection.
- fig. 13 **BH341** For (4) AA Cells with Standard Snap Connection.
- fig. 14 **BH343** For (4) AA Cells with Standard Snap Connection.
- fig. 15 **BH363** For (6) AA Cells with Standard Snap Connection.
- fig. 16 **BH383** For (8) AA Cells with Standard Snap Connection.
- fig. 17 **BH3103** For (10) AA cell (UM-3) with solder lug Connection.
- fig. 18 **BH411** For (1) AAA cell (UM-4) with solder lug Connection.
- fig. 19 **BH421** For (2) AAA cell (UM-4) with solder lug Connection.
- fig. 20 **BH511** For (1) N cell (UM-5) with solder lug Connection.
- fig. 21 **BH521** For (2) N cell (UM-5) with solder lug Connection.
- fig. 22 **BH65** For (1) Large D Cell.
- fig. 23 **BH102** For (1) Large 9 Volt Flat Type.
- fig. 24 **BH910** For (1) 9V battery with standard snap Connection.
- fig. 25 **BH980** Metal clip for 9V battery.
- fig. 26 **BC9** 9 Volt Battery Snap, Insulated - 3" Leads.
- fig. 27 **2090** Fahnstock Clip - 3/4" Brass, Nickel Plated.



fig. 10



fig. 11



fig. 12



fig. 13



fig. 14



fig. 15



fig. 16



fig. 17



fig. 18



fig. 19



fig. 20



fig. 21

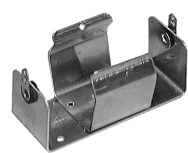

fig. 22

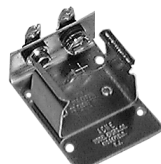

fig. 23



fig. 24



fig. 25



fig. 26



fig. 27