

Rectangular LED's

Infrared Emitting Diodes

These diodes are used in remote controls, Photo detectors, smoke detectors, etc.

3 mm (T-1) @ 50ma

Part Number	Max Forward Voltage	Typical Voltage	Viewing Angle
11-680	1.6V	1.4V	30°

5 mm (T-1 3/4) @ 50 ma

Part Number	Max Forward Voltage	Typical Voltage	Viewing Angle
11-681	1.6V	1.4V	45°

2 mm X 5 mm X 7 mm

Part Number	Forward Current (I _f) ma	Max Forward Voltage	Typical Voltage	LED Color	Viewing Angle
11-642	20 ma	2.0V	1.7V	Red	120°
11-643	20 ma	2.6V	2.0V	Orange	120°
11-644	20 ma	2.6V	2.1V	Yellow	120°
11-645	20 ma	2.6V	2.2V	Green	120°

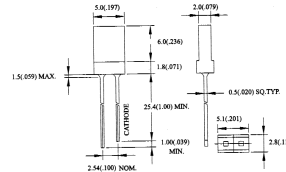

Square LED's

8 mm X 8 mm X 12 mm

Part Number	Forward Current (I _f) ma	Max Forward Voltage	Typical Voltage	LED Color	Viewing Angle
11-632	20 ma	2.6V	2.2V	Bright Red	140°
11-633	20 ma	2.6V	2.0V	Bright Orange	140°
11-635	20 ma	2.6V	2.2V	Bright Green	140°

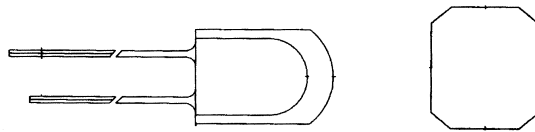

Press in Holders

Press

to fit holders, hold flangeless LED's snugly into mounting hole.

No. 11-400

3 mm LED (5.5 mm hole)

No. 11-401

5 mm LED (6.2 mm hole)

No. 11-404

5 mm LED (6.2 mm hole) with lamp support

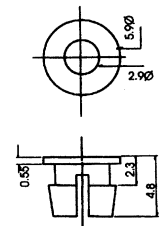

Silicon Photo Transistors

These devices are an electronic switch. When this unit is activated current is allowed to flow through the device. These items are used in Optical encoders, Automatic Control Systems, Photo Detectors and other applications where an optical switch is needed.

3 mm (T-1)

Part Number	Max Breakdown Voltage	Typical Voltage	Typical Carry Current	Viewing Angle
11-690	30V	5V	20 ma	30°

5 mm (T-1 3/4)

Part Number	Max Breakdown Voltage	Typical Voltage	Typical Carry Current	Viewing Angle
11-691	30V	5V	20 ma	35°



90° Surface Mt. Holders

Mount LED's at 90° to PCBoards

No. 11-409

3 mm Single

No. 11-410

5 mm Single

No. 11-412

5 mm Dual

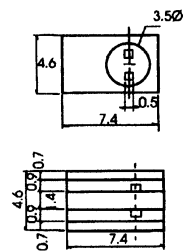

5 mm LED Lamp Holder

The holders hold a 5 mm LED (T-1 3/4). They are a chrome recessed style holder which mounts into a 8.2 mm hole with a hex nut.

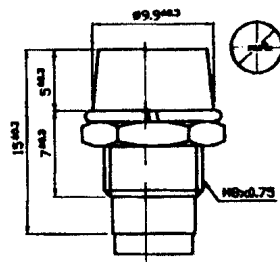

No. 11-480

Bi-Polar 8 mm LED

Lamps are in a recessed chrome bezel which holds a 8 mm LED that operates at 2V. The LED glows Red if current is applied in one direction and Green if applied in the other direction

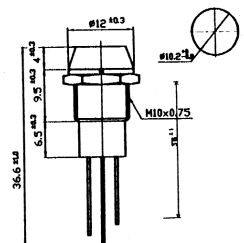

No. 11-352 Red / Green